



30 Galatea Road,

£225,000

 3  1  1



The Yorkshire Property Agency are delighted to introduce this fabulous semi-detached three bedroom family home located on a popular street in Yarm, TS15. 30 Galatea Road would make an ideal starter home and benefits from off-street parking and a high spec finish.

Key Features

- Semi-detached family home
- Downstairs WC
- Off-street parking
- Three bedrooms
- Landscaped garden
- Modern kitchen with integrated appliances

30 Galatea Road, Yarm, TS15 9GG

Ground Floor

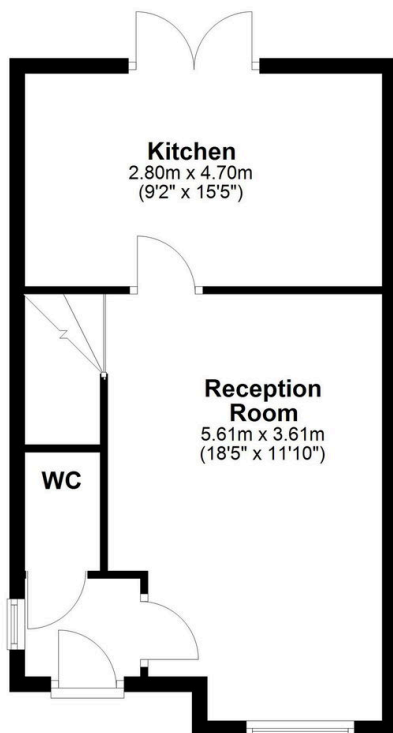

First Floor

