

## 22 Rosemoor Close,

£235,000

3 1 1



The Yorkshire Property Agency is delighted to introduce this stunning Grade II listed three-bedroom barn conversion situated in a popular cul-de-sac in Marton, TS7. This property boasts an attractive balance of a charming period exterior with a stylish and contemporary interior.

## Key Features

- Superb barn conversion
- Three double bedrooms
- Stylish interior
- Off-street parking for two cars
- Council tax band C
- Grade II listed
- South-west facing landscaped garden
- Three double-bedrooms
- Garage
- Close to all the local amenities of Marton, Nunthorpe and Coulby Newham

Ground Floor

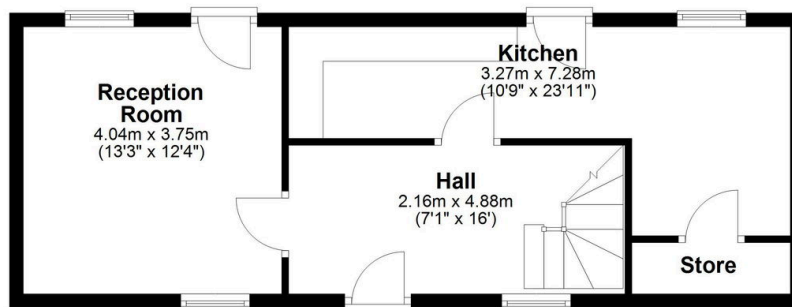

First Floor

